

**HSF**  
Compliant

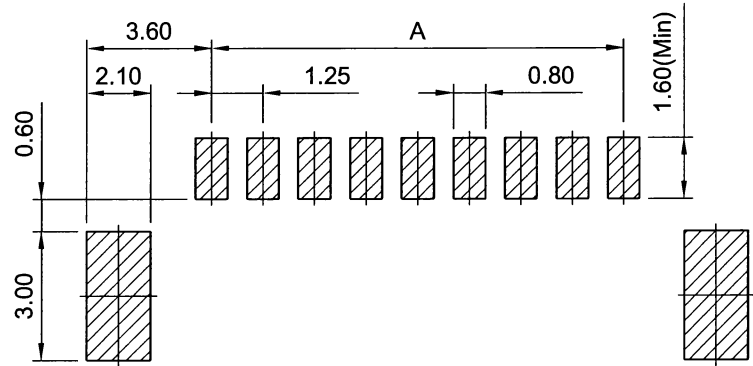
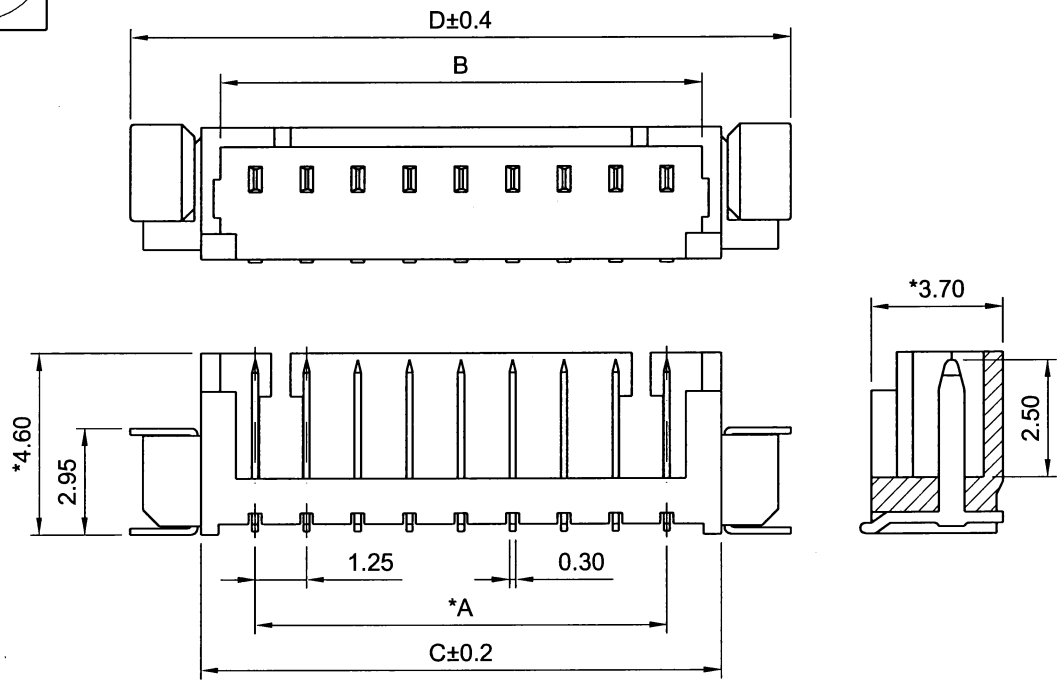

Recommended P.C.B. Layout

**Specifications**  
 Current & Voltage Rating : 1A & 125Vac max.  
 Insulation Resistance : 100 MΩ min.  
 Contact Resistance : 20 mΩ max.  
 Dielectric Withstanding : AC 250 V  
 Operating Temperature : -25°C ~ +85°C  
 Contact Material : Phosphor Bronze  
 Pad Material : Brass  
 Insulator Material : Nylon 46, UL 94V-0 (White)  
 Finish : Tin plated over Nickel  
 Packing : Tube

125C-SS-xxT  
 ↳ No. of contacts

No. of contacts	Dim. A	Dim. B	Dim. C	Dim. D
02	1.25	3.05	4.25	7.65
03	2.50	4.30	5.50	8.90
04	3.75	5.55	6.75	10.15
05	5.00	6.80	8.00	11.40
06	6.25	8.05	9.25	12.65
07	7.50	9.30	10.50	13.90
08	8.75	10.55	11.75	15.15
09	10.00	11.80	13.00	16.40
10	11.25	13.05	14.25	17.65
11	12.50	14.30	15.50	18.90
12	13.75	15.55	16.75	20.15
13	15.00	16.80	18.00	21.40
14	16.25	18.05	19.25	22.65
15	17.50	19.30	20.50	23.90

**JAWS** 兆旭股份有限公司  
 JAWS CO., LTD.  
 7F., No.31, Ln. 169, Kangning St., Xizhi Dist.,  
 New Taipei City 221, Taiwan (R.O.C.)  
 TEL:886-2-2692-2898  
 FAX:886-2-2692-2618  
 Http://www.jaws.com.tw

THIRD ANGLE PROJECTION  
 DESIGN UNITS: mm INCH  
 SIZE: A4 SCALE: FREE SHEET: 1/1  
 CPN: DAN NO.: S10101-012

TITLE: 1.25mm Wafer SMT Top Entry  
 PARTS NO.: 125C-SS-xxT  
 DWG NO.: JAWS-SOP-125C004  
 REV. 01

GENERAL TOLERANCES:  
 X. ±N/A  
 X.X ±0.30  
 X.XX ±0.20  
 ANGLE ±N/A

DRAWN: 游熾瑩  
 CHECKED: Wang  
 APPROVED: [Signature]

DATE: 2012/01/11  
 DATE: 2012/01/11  
 DATE: 2012/01/11